



# INSTALLATION MANUAL

Stadium 22S

Stadium 32S

Stadium 52F

Stadium 52CF

Stadium 62F

Stadium 62CF

Stadium 192T

Stadium 862F

Stadium 862CF

Stadium 962C

Stadium 962M

# Stadium 22S

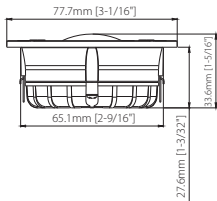
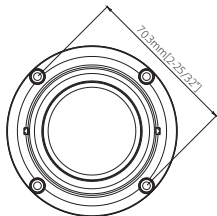
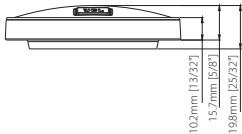
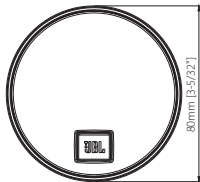

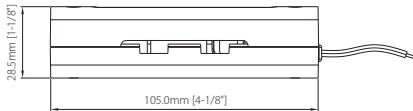
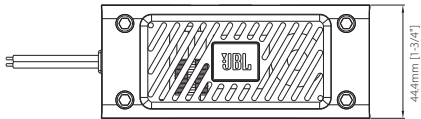
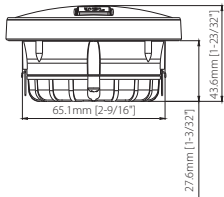
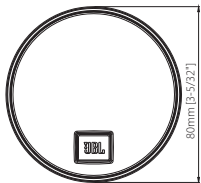

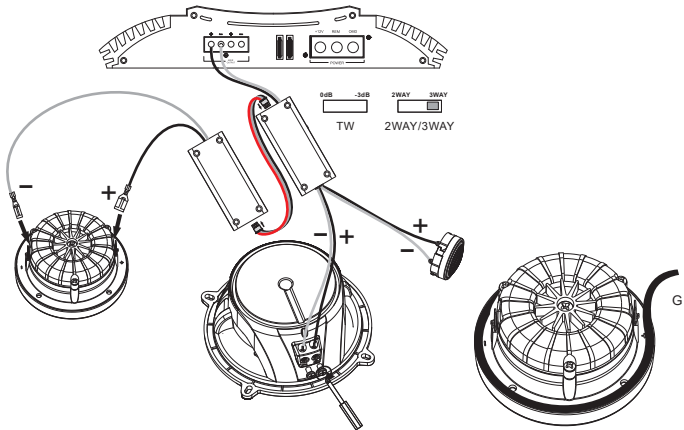

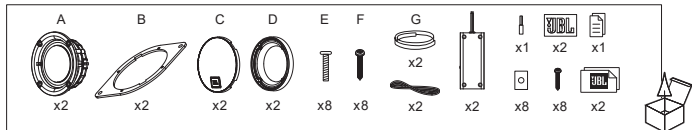
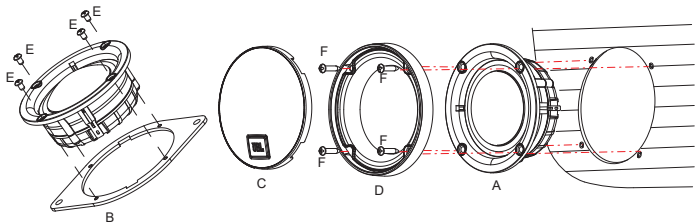

## Specifications

- Type: 2" (50 mm) PEI Dome Midrange with Bandpass Crossover Enclosure
- Power Handling: 50 Wrms, 150 W peak
- Sensitivity (@ 2.83 V): 94 dB
- Frequency Response: 500 Hz – 7 kHz
- Impedance: 3.0 ohms

## Thiele-Small Parameters

- Crossover Point: 600 Hz

# Stadium 32S

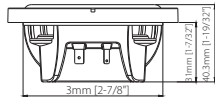
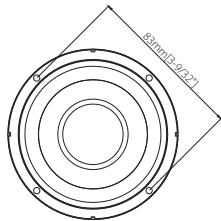
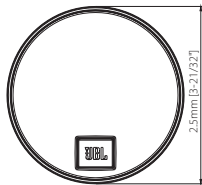

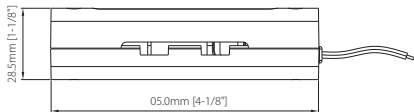
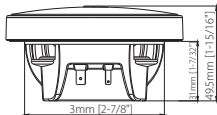
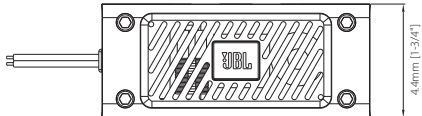
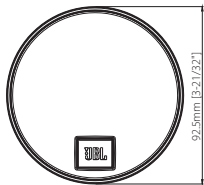



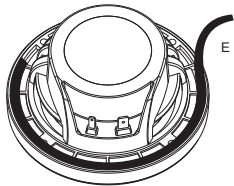
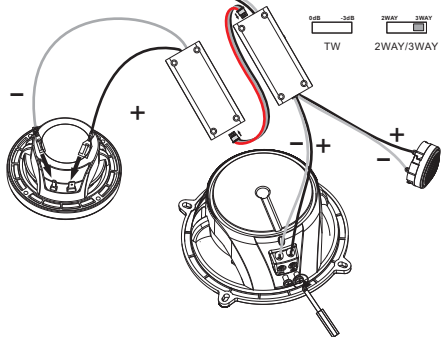
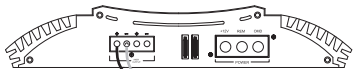

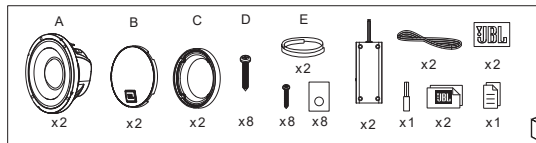
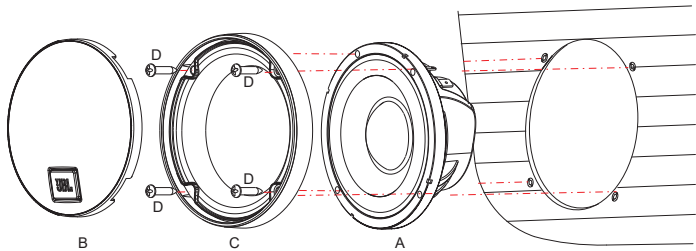

## Specifications

- Type: 3" (89 mm) Midrange with Bandpass Crossover Enclosure
- Power Handling: 55 Wrms, 165 W peak
- Sensitivity (@ 2.83 V): 93 dB
- Frequency Response: 200 Hz – 15 kHz
- Impedance: 3.0 ohms

## Thiele-Small Parameters

- BL (Tm): 5.64
- DCR (ohms): 2.7
- Mms (g): 4.964
- Sd (cm<sup>2</sup>): 35.26
- Cms (mm/N): 0.113
- Vas (l): 0.198
- Fs (Hz): 212.9
- Qes: 0.58
- Qms: 12.282
- Qts: 0.554
- Crossover Point: 300 Hz

# Stadium 52F

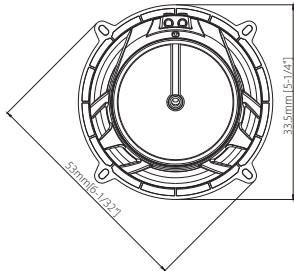
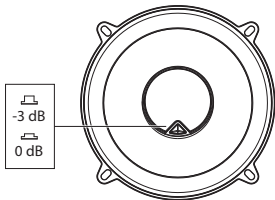
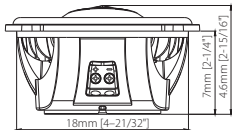

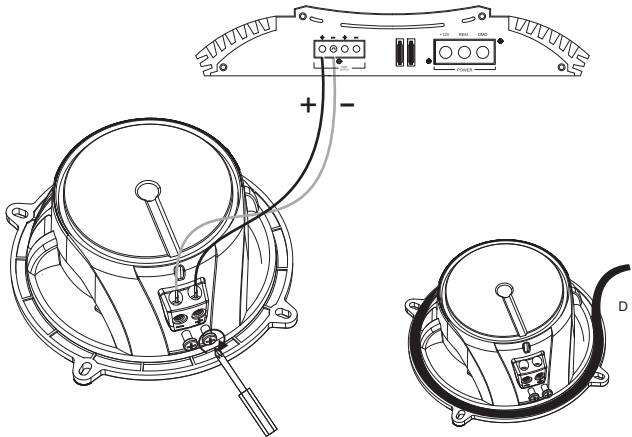

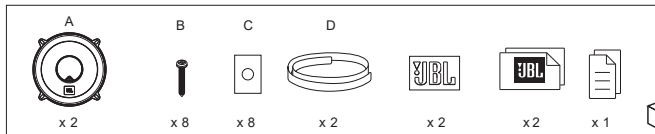
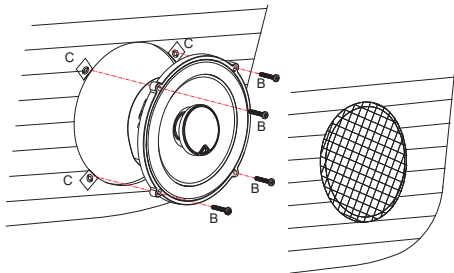

## Specifications

- Type: 5-1/4" (133 mm) Two-Way Car Speaker
- Power Handling: 60 Wrms, 180 W peak
- Sensitivity (@ 2.83 V): 93 dB
- Frequency Response: 55 Hz – 40 kHz
- Impedance: 3.0 ohms

## Thiele-Small Parameters

- BL (Tm): 3.88
- DCR (ohms): 2.70
- Mms (g): 9.82
- Sd (cm<sup>2</sup>): 102.07
- Cms (mm/N): 0.40
- Vas (l): 5.95
- Fs (Hz): 79.90
- Qes: 0.92
- Qms: 6.85
- Qts: 0.81
- Crossover Point: 4.6 kHz

# Stadium 52CF

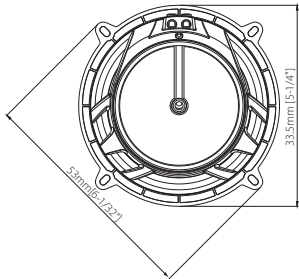
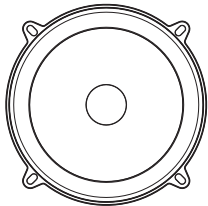
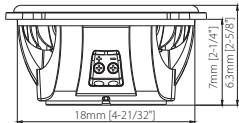



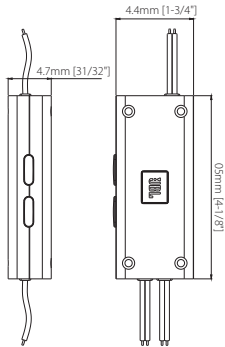
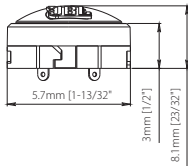
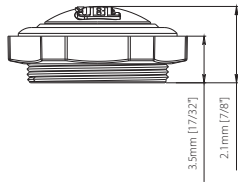
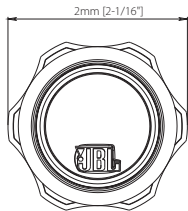

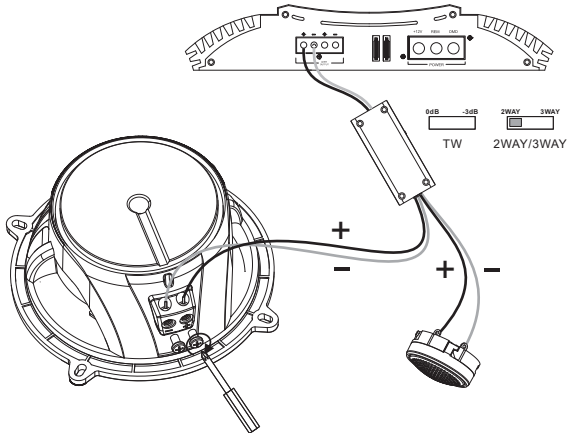

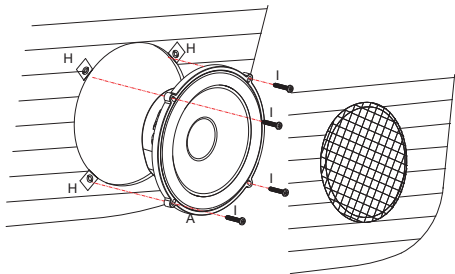

x2



x2



x2



x2



x2



x2



x6



x16



x8



x2



x1



x8



x2



x2



x1



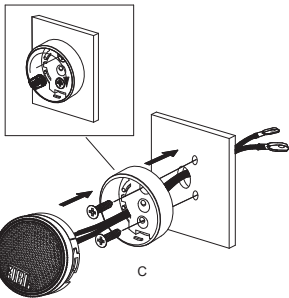
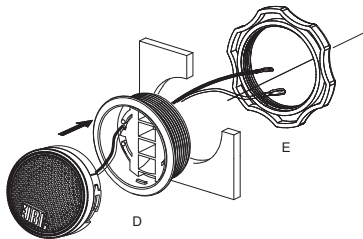
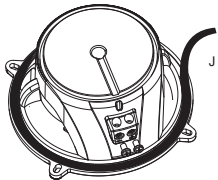

## Specifications

- Type: 5-1/4" (133 mm) Two-Way Component Speaker System
- Power Handling: 80 Wrms, 240 W peak
- Sensitivity (@ 2.83 V): 93 dB
- Frequency Response: 55 Hz – 40 kHz
- Impedance: 3.0 ohms

## Thiele-Small Parameters

- BL (Tm): 3.96
- DCR (ohms): 2.70
- Mms (g): 11.42
- Sd (cm<sup>2</sup>): 102.07
- Cms (mm/N): 0.40
- Vas (l): 5.89
- Fs (Hz): 74.50
- Qes: 0.92
- Qms: 6.98
- Qts: 0.81
- Crossover Point: 4.0 kHz

# Stadium 62F

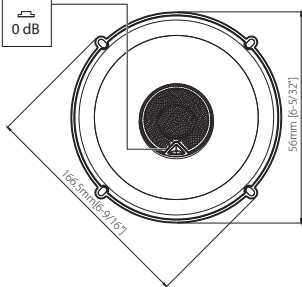
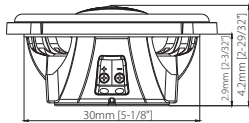
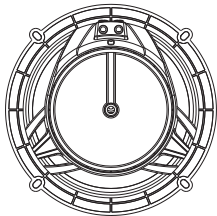



+ -

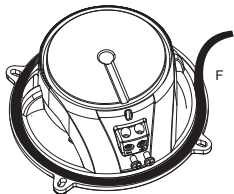
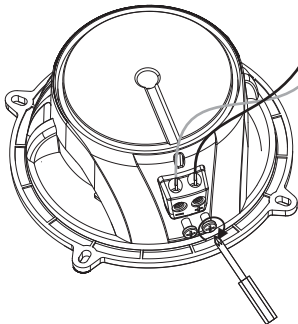

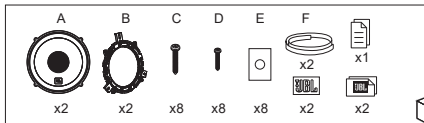
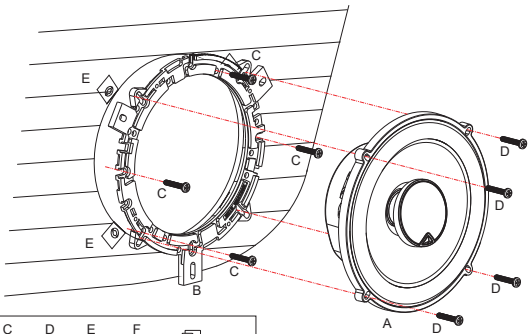



## Specifications

- Type: 6-1/2" (165 mm) Two-way Car Speaker
- Power Handling: 85 Wrms, 255 W peak
- Sensitivity (@ 2.83 V): 93 dB
- Frequency Response: 45 Hz – 40 kHz
- Impedance: 3.0 ohms

## Thiele-Small Parameters

- BL (Tm): 4.23
- DCR (ohms): 2.70
- Mms (g): 14.23
- Sd (cm<sup>2</sup>): 143.14
- Cms (mm/N): 0.24
- Vas (l): 6.99
- Fs (Hz): 86.00
- Qes: 1.19
- Qms: 11.31
- Qts: 1.08
- Crossover Point: 4.6 kHz

# Stadium 62CF

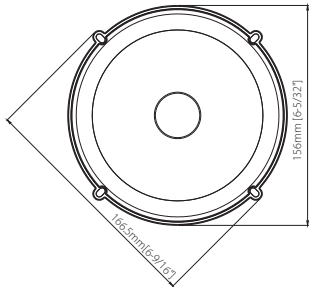
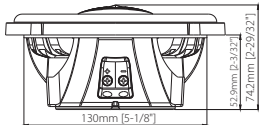
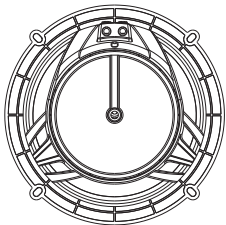

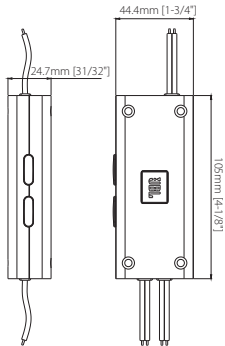
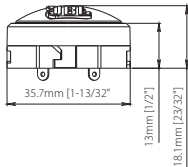
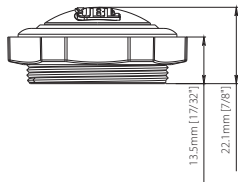
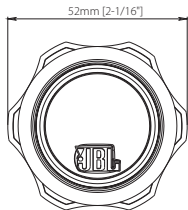

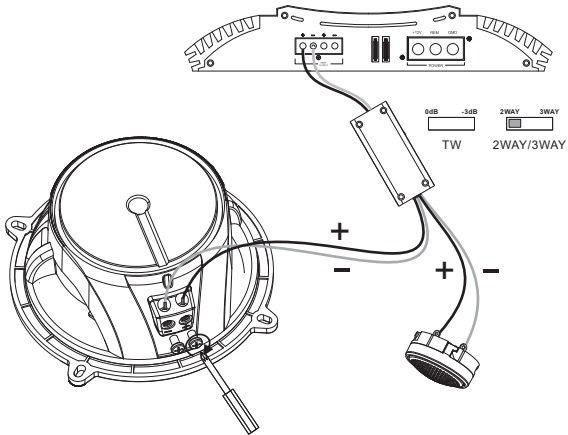

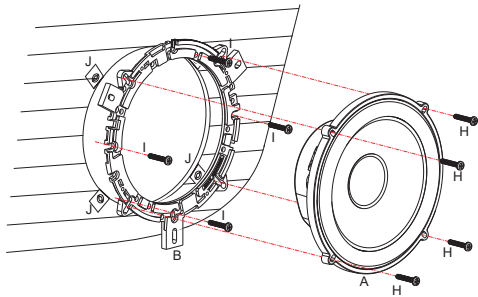

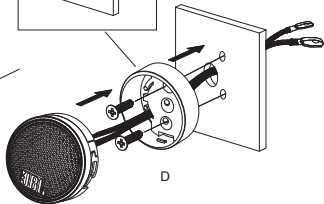
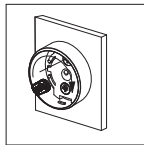
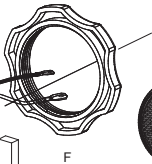
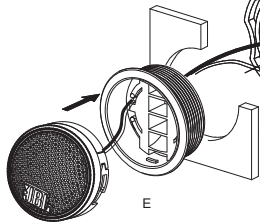
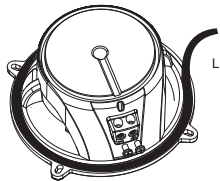

## Specifications

- Type: 6-1/2" (165 mm) Two-way Component Speaker System
- Power Handling: 110 Wrms, 330 W peak
- Sensitivity (@ 2.83 V): 93 dB
- Frequency Response: 45 Hz – 40 kHz
- Impedance: 3.0 ohms

## Thiele-Small Parameters

- BL (Tm): 4.45
- DCR (ohms): 2.70
- Mms (g): 14.62
- Sd (cm<sup>2</sup>): 143.14
- Cms (mm/N): 0.25
- Vas (l): 7.34
- Fs (Hz): 82.70
- Qes: 1.02
- Qms: 8.47
- Qts: 0.91
- Crossover Point: 4.6 kHz

# Stadium 192T

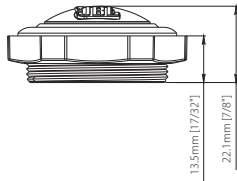
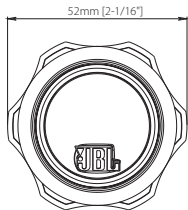
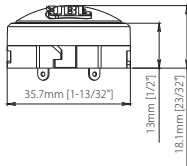



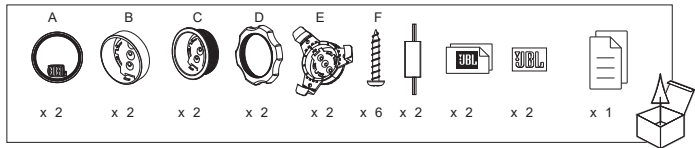
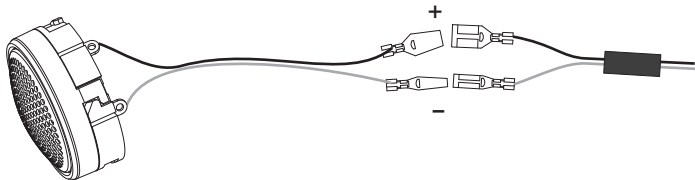

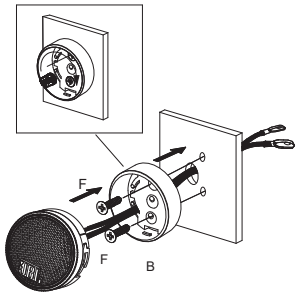
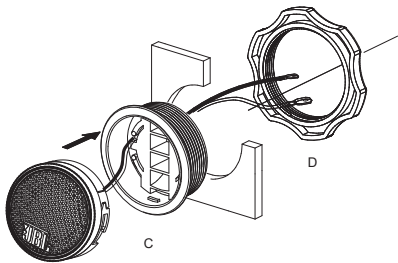

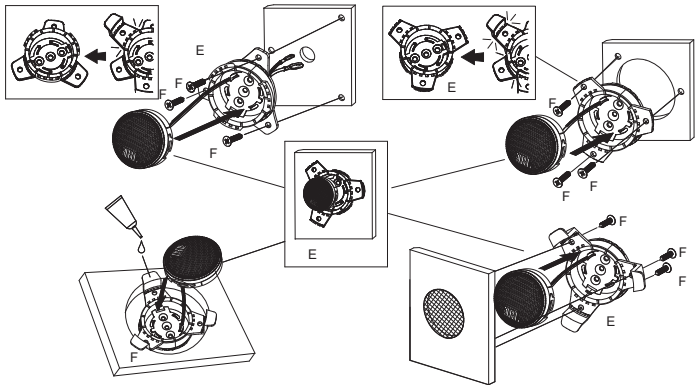

## Specifications

- Type: 3/4" (19 mm) Edge-Driven Aluminum Dome Tweeter
- Power Handling: 50 Wrms, 150 W peak
- Sensitivity (@ 2.83 V): 93 dB
- Frequency Response: 2 kHz – 40 kHz
- Impedance: 3.0 ohms

## Thiele-Small Parameters

- Crossover Point: 4.6 kHz

# Stadium 862F

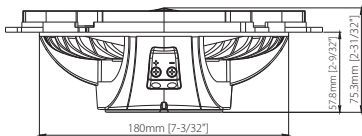
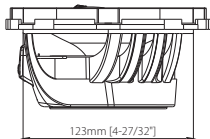
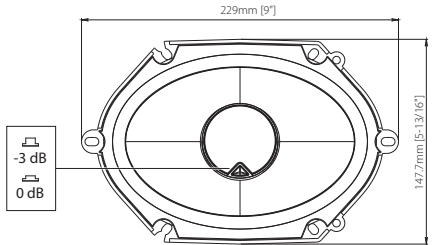

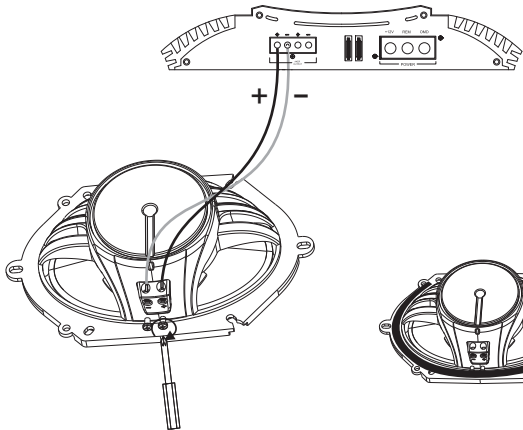

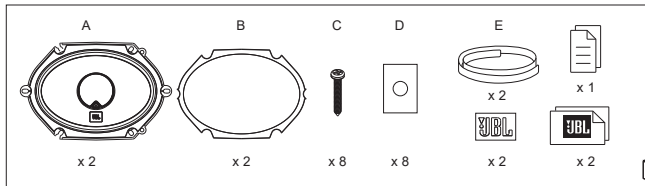
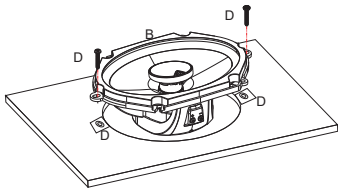
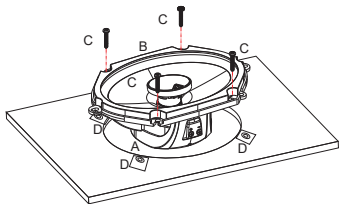

## Specifications

- Type: 6" x 8" (147 mm x 205 mm)  
Two-way Car Speaker
- Power Handling: 100 Wrms, 300 W peak
- Sensitivity (@ 2.83 V): 93 dB
- Frequency Response: 40 Hz – 40 kHz
- Impedance: 3.0 ohms

## Thiele-Small Parameters

- BL (Tm): 4.66
- DCR (ohms): 2.70
- Mms (g): 17.58
- Sd (cm<sup>2</sup>): 167.42
- Cms (mm/N): 0.25
- Vas (l): 9.94
- Fs (Hz): 75.80
- Qes: 1.03
- Qms: 10.19
- Qts: 0.93
- Crossover Point: 4.1 kHz



# Stadium 862CF

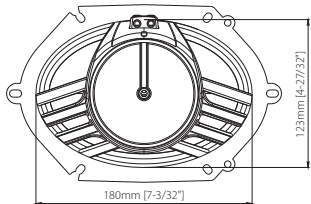
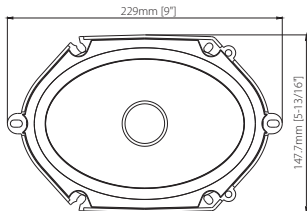
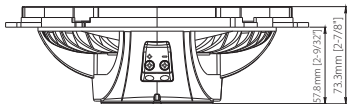

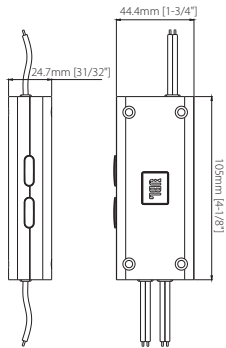
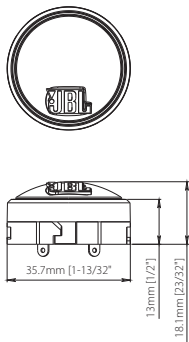
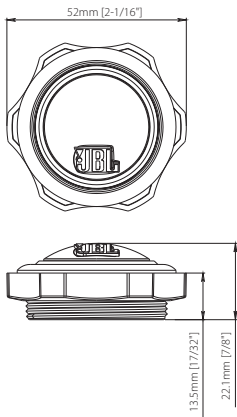

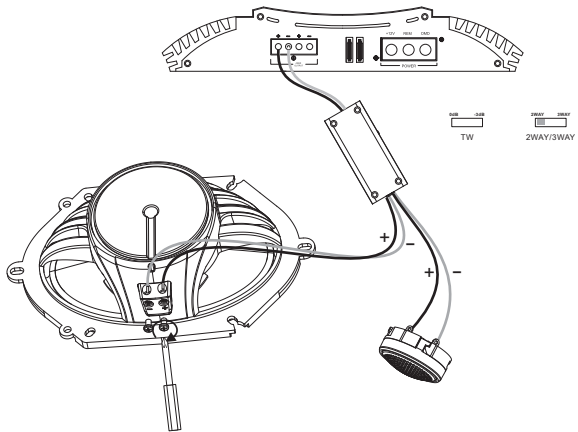

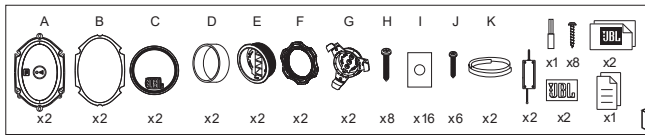
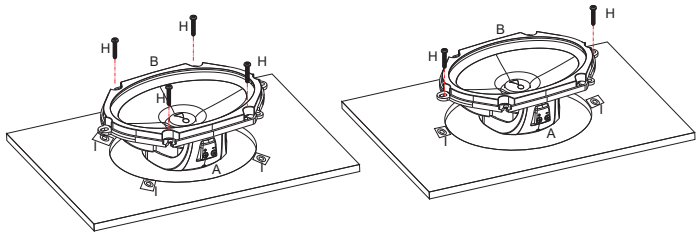

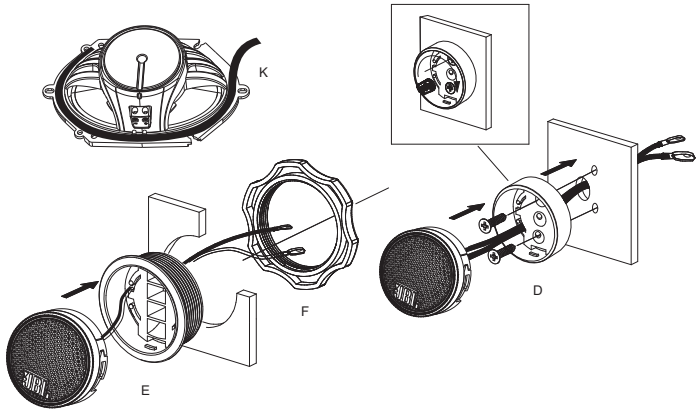

## Specifications

- Type: 6" x 8" (147 mm x 205 mm)  
Two-way Component Speaker System
- Power Handling: 120 Wrms, 360 W peak
- Sensitivity (@ 2.83 V): 93 dB
- Frequency Response: 40 Hz – 40 kHz
- Impedance: 3.0 ohms

## Thiele-Small Parameters

- BL (Tm): 4.70
- DCR (ohms): 2.70
- Mms (g): 16.74
- Sd (cm<sup>2</sup>): 167.42
- Cms (mm/N): 0.28
- Vas (l): 11.06
- Fs (Hz): 73.70
- Qes: 0.97
- Qms: 6.16
- Qts: 0.84
- Crossover Point: 4.0 kHz

# Stadium 962C

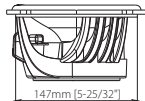
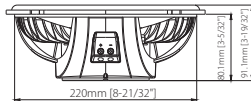
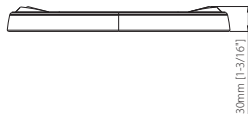
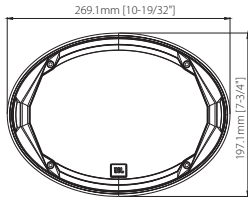
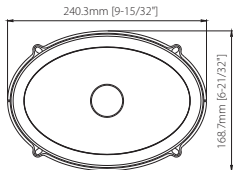

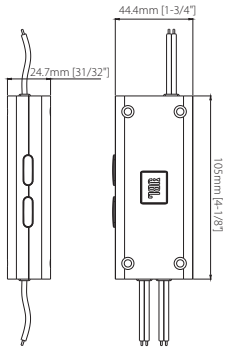
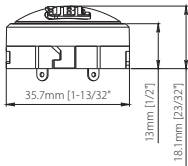
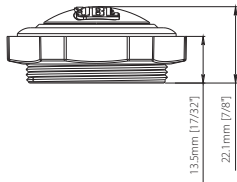
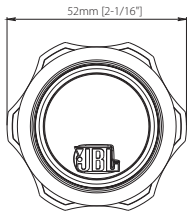



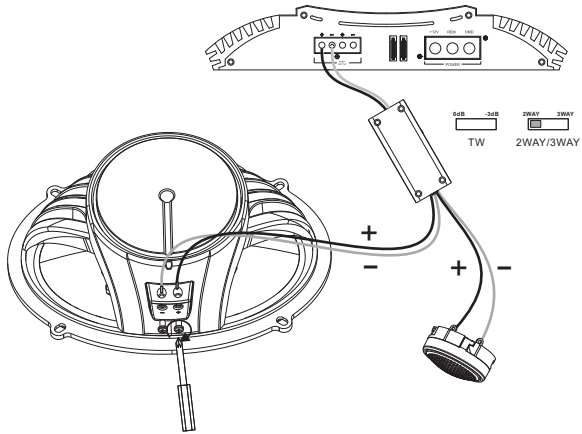

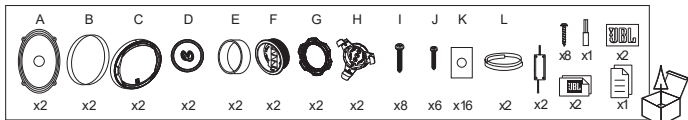
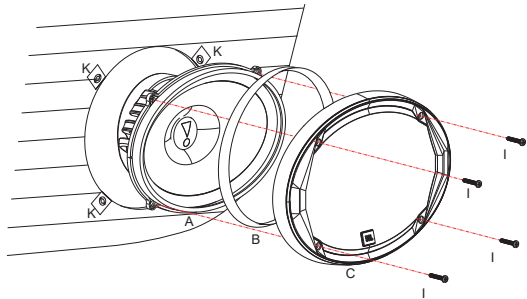

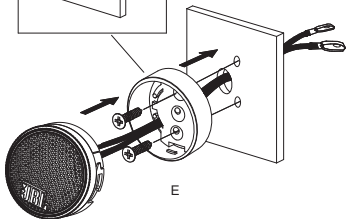
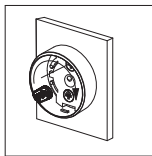
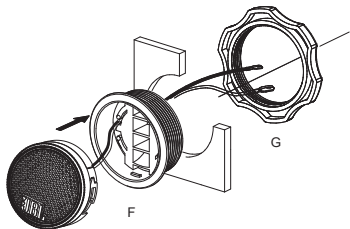
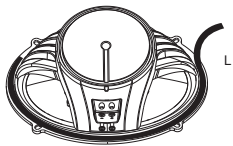

## Specifications

- Type: 6" x 9" (168 mm x 240 mm)  
Two-way Component Speaker System
- Power Handling: 145 Wrms, 435 W peak
- Sensitivity (@ 2.83 V): 94 dB
- Frequency Response: 35 Hz – 40 kHz
- Impedance: 3.0 ohms

## Thiele-Small Parameters

- BL (Tm): 6.162
- DCR (ohms): 2.70
- Mms (g): 28.033
- Sd (cm<sup>2</sup>): 248.85
- Cms (mm/N): 0.34
- Vas (l): 29.7588
- Fs (Hz): 51.6
- Qes: 0.671
- Qms: 7.374
- Qts: 0.615
- Crossover Point: 3.9 kHz

# Stadium 962M

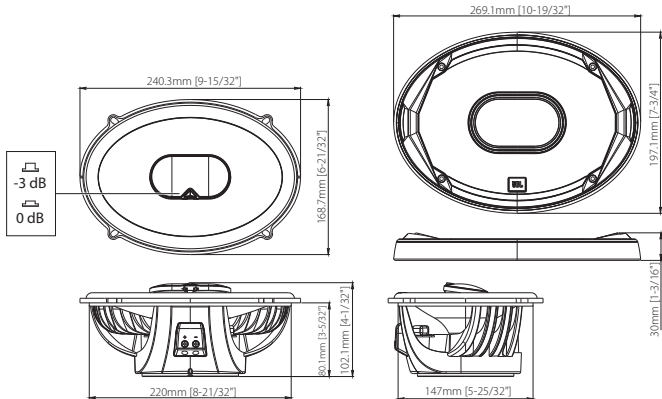

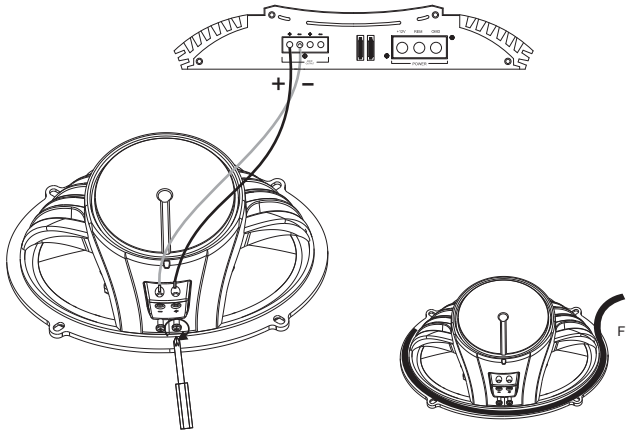

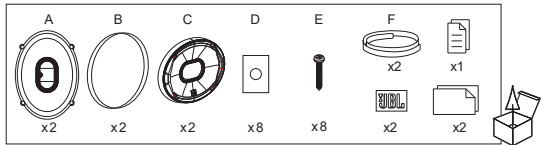
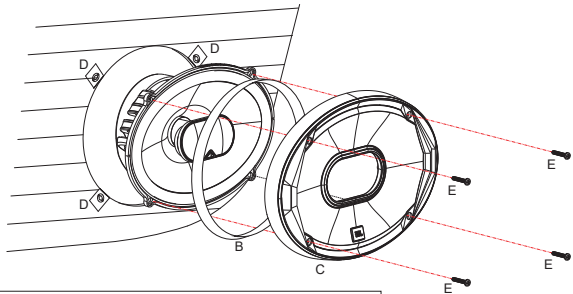

## Specifications

- Type: 6"x 9" (168 mm x 240 mm)  
Three-way Car Speaker
- Power Handling: 120 Wrms, 360 W peak
- Sensitivity (@ 2.83 V): 94 dB
- Frequency Response: 35 Hz – 40 kHz
- Impedance: 3.0 ohms

## Thiele-Small Parameters

- BL (Tm): 6.578
- DCR (ohms): 2.70
- Mms (g): 27.904
- Sd (cm<sup>2</sup>): 248.85
- Cms (mm/N): 0.24
- Vas (l): 21.0071
- Fs (Hz): 61.5
- Qes: 0.741
- Qms: 8.637
- Qts: 0.682
- Crossover Point: 3.9 kHz





HARMAN International  
Industries, Incorporated 8500  
Balboa Boulevard, Northridge,  
CA 91329 USA

© 2021 HARMAN International  
Industries, Incorporated.

All rights reserved.

JBL is a trademark of HARMAN International Industries,  
Incorporated, registered in the United States and/or other  
countries.

Features, specifications and appearance are subject to change  
without notice.